



WENDOVER ARM NEWS

Newsletter of the Wendover Arm Trust



*Issue 2016/1
Spring 2016*

*Price £1 where sold
Free to members*

By choosing a Guild Member
such as

Renewal due 2016-04

ORCHID ESTATE AGENTS

will help you achieve a far
better
result!

- 
- Orchid have been exclusively selected by The Guild. We connect to a national network of over 750 independent guild estate agents.
 - With External touchscreens at our Park Lane property centre showcasing all of our properties to the lucrative London and international investor market 24/7.
 - Our regional magazines produced by the Guild delivers your property widespread exposure across the 750 member agency offices.



If your considering selling or renting your home.
Call your local national award winning Guild agent
today on **01442 89 00 22** or visit us at
www.orchidproperties.co.uk



Your contacts on the Trust

Chairman	Chris Sargeant chairman@wendoverarmtrust.co.uk
Vice-Chairman	vacant
Hon. Secretary	John Rowe johnm.rowe@talktalk.net
Treasurer	Clive Wilson treasurer@wendoverarmtrust.co.uk
Restoration Director	Roger Leishman restoration@wendoverarmtrust.co.uk
Assistant Restoration Director	Ray Orth restoration2@wendoverarmtrust.co.uk
Events Director	vacant events@wendoverarmtrust.co.uk
Funding Director	vacant funding@wendoverarmtrust.co.uk
Membership Secretary	Katherine Deaney membership@wendoverarmtrust.co.uk
Publications Director	David Page newsletter@wendoverarmtrust.co.uk
Publicity Director	Nigel Williams publicity@wendoverarmtrust.co.uk
Sales Director	Bob Wheal sales@wendoverarmtrust.co.uk
Webmaster	Chris Sargeant webmaster@wendoverarmtrust.co.uk
General Members	Charlie Carrington (Health & Safety) charlie_carrington@hotmail.com
	Marion Birch (Facebook) marion.birch@ntlworld.com
Minutes Secretary and IWA Nominee	Jenny Brice jenny@johnbrice.co.uk
CRT Representative	Vicky Martin Vicky.Martin@canalrivertrust.org.uk

In this issue

	page
Editorial	4
From the Editor	5
Letters	7
Restoration Update	9
WAT Shopfront	11
Whitehouses – How it Works	12
Bulbourne Yard Redevelopment	13
Volunteers' Lunch	14
HLF Liaison Meeting Report	16
Chiltern Branch IWA	18
From the Archives	19
Tringford Pumping Station	19
CRT Work Party on the Arm	20
Donations	21
Grand Draw	22
News from our Neighbours	22
Membership Update	23
Club 100	25
Help Wanted	25

ADVERTISERS

Orchid Estates	2
Barton Petroleum	28
Cowroast Marine Engineering	28
Digital Services	28
Green Park Activity Centre	26
Heygates	15
Market Auto Centre	24
The Anglers Retreat	28
Tring Brewery	27
Wyvern Shipping	28
Your Café in the Park	6

**Copy deadline for the summer issue
20 May 2016**

Chairman's column



The nights are getting lighter and the rain warmer so spring must be on the way!

Despite the 'quiet' time of year there has been considerable activity on our patch, the social highlight of which was our restoration volunteers lunch at The Café in the Park in January which was well attended and appreciated. We are planning a summer event in July possibly a Barbeque at the same venue which has a large patio and of course the park but also the 'indoors if wet' option if needed. More information later.

CRT's contractors have been busy in February weed cutting and trimming and tidying banks – this necessary work has now freed constricted water flows which were a potential flood hazard

and were starving supplies of water to Wilstone reservoir which has become very low as a result and causing concerns to hire boat operators on the GU. This work is always done in the October to February period in accordance with their environmental code.

A group of CRT Volunteers tackled more weed removal at Aston Clinton and tidying up around Tringford pumping station Feb 19/20th. We are grateful for their support.

As I write we are getting close to hearing the outcome of our lottery funding application – as soon as we hear it will be published on our web site.

We have a full programme of events for the year and offers of help will be appreciated – especially in setting up and taking down our gazebo – also volunteers to tow our trailer so that we can 'spread the load.' Please email events@wendoverarmtrust.co.uk org tel: 07547 181857.

We look forward to another year of progress – thank you for your continuing

WAT AGM 2016

**19 October at Green Park
With a meal and speaker**

**Details in summer Newsletter.
Save the date**

From the Editor

A few weeks ago I was in conversation with a couple of members who were reminiscing about the 'old days' of the festival and how they managed to get their (long) boats up past the New Mill winding point when the stop lock was as far as you could get. I remarked that I had a picture of the 'Dr Doolittle' technique for getting anything longer than a skiff up to the pumping station and was asked to print it so here it is as our cover feature this issue. Sorry it's only black and white but it does evoke the era.

As Chris in his chairman's column identifies we expect the answer to our bid soon and it should come around the time this Newsletter drops through your letter box. Look on the website

www.wendoverarmtrust.co.uk for the outcome. If the answer be 'yes' then there's a great deal of work that the Trust and CRT needs to do to submit the detailed proposal by November. If the answer be 'no' then Council has a lot of work to do to define 'plan B.' Simon

Salem who was elected as a Council Member at the AGM specifically to help us with this and other funding initiatives has had to tender his resignation but will continue to help with the HLF bid.

I've put three items in this issue that strictly speaking are not WAT restoration items but do affect the general regeneration of the Arm and its environs. The first is a report on CRT's clearance days in February, the second is CRT's proposals for renovation of Tringford pumping station and the third is the proposals for getting 'life' back into Bulbourne yard. Trust you find them interesting.

What's more, in this issue we actually have a couple of letters to the Editor and a member's small ad. Good to know that there is someone out there!

And still no space for another 'Editor's cookery column' despite my having a number of recipes in the file ready to share with you.

Correction

We regret there was an error in the obituary to Oliver Statham published in the winter 2015 Newsletter. We stated that Oliver was not a member of WAT, in fact he and his wife Ann joined in 2004 and took out Life Membership in 2012 when the Trust introduced it.

He was a generous donor to the Trust. He made regular donations in addition to his subscriptions, £50 here, £80 there, £40 etc. He was a club 100 member from 2010 until his death.

As a Wendover resident he was a vocal supporter of the canal, WAT and restoration, when other Wendover residents could be quite hostile towards WAT.

We apologise misinforming our readers and for any distress it may have caused his family.



BARBECUE

SATURDAY 14 MAY NOON—3PM

AT



All welcome

TICKETS

£10

Tickets, including a drink on arrival (soft or alcoholic,) available from the Events Coordinator.

Booking form with this Newsletter

Book early (latest 7 May), numbers limited to 80

Vegetarian option available, please specify when booking.

Cash bar/café

TICKETS

£10

your
café
in the Park

ASTON CLINTON

Open daily from 8.30am all year round, Your Café in the Park is a family run business located in the beautiful surroundings of Aston Clinton Park.

We pride ourselves on offering locally sourced, handmade fresh produce and also have a spacious function room which is available for booking with catering options.

For our younger visitors Soft Play is also available at certain times during the week.

For enquiries, please email:
yourcafeinthepark@gmail.com

Letters to the Editors

Editor's note: If you read the 'new members' list in our winter 15 Newsletter you might have wondered why someone from Londonderry has joined us. Here's the story:

Londonderry, 10th Nov 2015

Hi,

My story is really of the wheel going full circle, as follows. My grandfather who, following service in the second Boer War, had been in the army reserve and having moved his family to Ireland rejoined the army at age 40 with the Inniskillings 36th Ulster Division and served at Finner Camp in Donegal as a sergeant, army documents list him as an instructor.

The family's origins are in Buckinghamshire, the earliest record I have is of a Philip Ming and Mary Butler being married in Quainton in 1688, there are records of the family in various locations throughout the County including a Ming Cottage in Weedon and one as an publican in Great Milton, Oxon, I do have a complete family history

My reference to the wheel travelling full circle is the moving of one of our daughters to Aylesbury with her husband and subsequently to Stoke Mandeville almost 30 years ago, we now have another granddaughter from Londonderry living and practising as a speech therapist in Bucks and yet another granddaughter presently at University in Hatfield, it sometimes feeling a little like returning home.

It was when visiting our daughter and her family that I first became aware of and interested in the Grand Union Canal and subsequently the Wendover Arm, I

really enjoy visiting the canal and seeing the progress made between each visit as well as following progress with the restoration reports every other month from you excellent restoration site.

I have always admired the work carried out by your volunteers and their commitment to the restoration and am delighted at your invitation to become a member of the Trust.

Arthur Ming

Feeling Smug

27 January 2016

Hello,

I signed up for Easyfundraising earlier in the year and to my amazement I have reached a milestone amount which prompted me to put pen to paper in a rather cheesy attempt to cajole others into joining up.

If you can make use of this then please feel free. Whether it can be used or not I have been moved to match the sum so please find a cheque enclosed for the fighting fund.

(Name and address supplied)

"I'm sitting here feeling . . . smug. I did it today and definitely feel smug. You see I did nothing at all really, but I had a sort of goal. So I pressed a few extra on-screen buttons before increasing the profits of Amazon, John Lewis et al. But today they told me that I had raised £100.51 for the Trust.

That was the target – £100

(Continued on page 8)

(Continued from page 7)

Hence smug.

If you're still with me, allow me to explain. In June last year I signed up with Easyfundraising to raise donations for the Trust. Being a retired (read: lazy) person this seemed to be a good idea. I would not spend an extra penny and the companies that I bought from would donate money to the trust via the nice people at Easyfundraising.

And they did. And it was easy. Easyfundraising provided a small piece of software called a browser add-on* and now when I Google (is that really a verb?) for new toys, websites that are part of the scheme are marked up with their donation with an **e** in front of the heading and the web address and the legend 'Easyfundraising partner (up to x% donation.)'

Easyfundraising provides details of who gave what and how much you and others have

raised to date and of course, you can withdraw from the scheme at any time.

As I write this, 39 trust members have signed up and raised £671.52** without spending an extra penny. If we all joined then that would be £000s more so, please, give it a try. It will not cost you anything except a few extra seconds of your time. It just has to be worth it."

** may not work with some browsers*

***at the time of going to press the total had reached £782.83 with 41 members*

A graphic for Easyfundraising featuring a large white speech bubble on a dark background. Inside the bubble, the text reads: 'Psst...! Raise free donations when you shop online!'. Below this, there is a numbered list: 1 Visit: www.easyfundraising.org.uk, 2 Support: Wendover Arm Trust, 3 Shop & raise with over 2,700 retailers including: amazon, Argos, Expedia, John Lewis. The Easyfundraising logo and website address .org.uk are in the bottom right corner of the bubble.

Psst...!
Raise **free** donations when you shop online!

- 1 Visit: www.easyfundraising.org.uk
- 2 Support: Wendover Arm Trust
- 3 Shop & raise with over 2,700 retailers including:
amazon Argos Expedia John Lewis

easyfundraising
.org.uk

COWROAST MARINE ENGINEERING

- *Full size narrow boat covered slipway
- *Slipway hire for DIY hull blacking
- *Slipway for surveys
- *Welding/over plating
- *Gas work/heating and plumbing services
- *Electrics
- *New engine fitting
- *Engine work/engine servicing

Cowroast Marine Engineering is run by Darren Killick with 27 years of marine engineering experience. All engineering from fitting a light bulb to a brand new engine installation undertaken. We use top quality marine equipment for a top quality result.

Tel: 01442 825522 or 07941 240024
Cowroast Marine Engineering, Cowroast, Tring, HP23 5RE

RESTORATION NEWS

Adapted from Roger Leishman's restoration group's newsletters



. . and the rains came down again (but at least we didn't have the floods that other parts of the country suffered.)

Weather conditions have slowed work on lining Stage 3 and no

concrete has been poured since October; priority was given to excavation and works associated with Whitehouses.

January and February 2016

Excavation and backfilling was all we could do during these months owing to the bad weather but the work including capping is now mainly complete to within 100m of the end of Stage 3.

On the offside, behind the pipe capping the bank is being restored in carefully laid shallow layers of spoil consolidated by the plant operating over it; the bank had to be removed to access the pipe to allow it to be capped. On the towpath side the bank is being rough profiled ready for the re-lining process in due course.

When we couldn't operate plant some 'hospital' jobs were tackled. Foremost of these was to uncover all the manholes between Little Tring and Bridge 4A to allow the bed to drain quickly after rain, this length is notorious for its pools of water. We also put in a new fence at Bridge 4A and laid the base for the Stuart Bell memorial seat by the public footpath leading to Wilstone reservoir – the seat will be emplaced in March.

After what seems a long time of starts and stops CRT has now completed all its

work at Whitehouses and the finished work plus an explanation of what happens is described in an associated article on page 12.

We have had discussions with CETCO regarding new developments over the use of Bentomat since last supplied in 2008 and we are strongly recommending to CRT that the new type with a special back lining is used. Pleasingly the cost of the new type of Bentomat is less than had been estimated for the remainder of Phase II.

Future Work

When the weather improves we shall continue the work of pipe-capping through into stage 4 (Whitehouses to Bridge 4.) The bed across the wharf front requires special attention which may require a concrete bed similar to those at bridge locations and KESCRG are booked to come for a weekend in May when they will make a start on landscaping the whole of the Whitehouses area.

Phase II vegetation maintenance

The appeal for help with vegetation maintenance so far has produced only two firm volunteers and, hopefully a third.

We want to get a gang together that will improve the general tidiness of the canal between Little Tring and Drayton

Beauchamp, including the Whitehouses site.

If you feel you want to help with scrub bashing (reminds one of the work parties of 80s doesn't it?) then please get in touch with Roger Leishman

✉ restoration@wendoverarmtrust.co.uk
or ☎ 07547 181857 and we'll start as soon as the weather improves.

Watch out, watch out, there's a surveyor about.

If you've been walking along the Arm towards the Wendover end recently you may have seen gentlemen with surveying instruments and wondered what they were doing. Don't worry, nothing sinister is happening; these are CRT's people making a survey of Phase III to determine what will need to be done and what the costs will be to strengthen

the banks in preparation for raising the water to the Tring Summit level. Don't get all excited though, nothing's going to happen in the near future. We'll keep you posted.

Work Party Dates

Subject to the vagaries of the British weather the next three months' working parties are:

Friday 1—Thursday 7 April

Friday 6—Thursday 12 May

Friday 3—Thursday 9 June

The work is pipe-capping and rough profiling the banks behind the capping works. The June Work Party includes Restoration Open Day Contact Ray Orth:

✉ restoration2@wendoverarmtrust.co.uk
if you want to volunteer.



in association with
St Mary the Virgin, Drayton Beauchamp



RESTORATION OPEN DAY

SUNDAY 5 June 2016 12.30 to 4pm

- Guided tours of the canal restoration site
 - See our volunteers at work
 - See the re-watered sections
- Sideshows Teas and cakes for sale
 - Bring a picnic and help celebrate
Her Majesty's 90th birthday

Free admission, donations welcome

Car parking at St Mary's Church, Drayton Beauchamp, HP22 5LS

WAT SHOPFRONT — A Retail Challenge

from the Sales Director

At home, we live in an ordinary house, with typical amenities. Lounge. Kitchen. Dining Room (even if we never eat there). Bathroom. Bedrooms.

Hidden away off the upstairs landing is the Tardis. The Black Hole of Calcutta. The Storage Room, otherwise known as 'The Office'.

There are mysterious boxes, bags, carriers, and containers. Mysterious because at first glance it's not clear what treasures are squirreled away, never to see the light of day.



And then . .

Now none of this is a problem except for one thing – the mini-mountain of containers, trays, and polybags never seems to get any smaller.

We are of course describing the cornucopia of delight which is the WAT Sales Stock.

However, you are in a very enviable position. You are able, with a single phone call or a couple of computer clicks to help reduce the mountain to a more manageable proportion, and indeed let some light in the window.

Choose any item from our range and the chances are that it will be in stock in your size or in the quantity you want, and ready to be shipped.

So what do we have?

- We have clothing in all the sizes and all the colours (as long as it's white for a T Shirt or Burgundy for a Cap or a Rugby/Sweat Shirt).
- Key Fobs, Lapel Badges, Guide Books, History Books, Colourful Mugs (in 2 sizes!), Greeting Cards,



.there were none – or almost!

Decorative Tea Towels etc.

Venture online to the Trust Website and you will soon see more information, pictures, and even prices, which of course include P&P. Stay well away from a computer (I wish!) and you can choose instead to call by phone.

With your help we can hopefully reduce the size of our stockpile and maybe even get to find out what's in that box at the back of the shelf. Thanks for reading this far.

wendoverarmtrust.co.uk/shop 07860 286155

Whitehouses –How it Works

There have been many reports before in the Newsletter of the works at Whitehouses but many of you 'not in the know' may be mystified as to the why and how so, here, with the help of some pictures is what happens.

Whitehouses is the water control point for feeding Wilstone reservoirs. At present the control valve for the pipeline under the bed of the canal is the paddle in the

square manhole at the rear that contains sluice valves that control the flow of



foreground of picture 1, this can be set to proportion water between the Wilstone and the Marsworth reservoirs.

Over the past three years WAT, KESCRG and CRT between them have reclaimed the area and have rebuilt the old control mechanism.

When the canal (on the right in picture 2) is re-watered water will enter the settling tanks through the culverts in the wharf wall on the right. The water level can be set by weir boards in the grooves in the brickwork in the centre. Overspill goes into the left-hand chamber and through the circular culvert into the



water into the former pumping shaft (just to the rear of the manhole) into Wilstone reservoir via underground culverts.

The finished works have grids over them for the public's safety (picture 3)





when Whitehouses is opened for their enjoyment.

Should the section between Drayton Beauchamp bridge and bridge 4 need to be drained then the paddle gear (see below, picture 4) in the wharf wall can be opened and water goes directly into the manhole and the culvert to Wilstone. The capstone over the paddle gear is the original one (seen being emplaced in picture 1) but the paddle gear is new.

Photos in this article by Roger Leishman

Regenerating Bulbourne Yard and Workshops

Canal & River Trust, together with H2O, are seeking to redevelop Bulbourne Yard (comprising four grade two listed buildings, two buildings of historical importance and three Victorian cottages). Bulbourne Yard is in desperate need of investment, and this development will give the area and the historical buildings a sustainable future.

The redevelopment of the site will generate much needed revenue for Canal & River Trust to reinvest in the canal network and also:

- Retain the significant heritage value of the site and respect the surrounding environment
- Retain the open nature of the site and “spirit” of a working yard
- Through the creation of a new pedestrian footbridge existing links are enhanced along with links to the nearby reservoirs and nature reserve
- Retain the wharf with open access and crane facility

- Improved open areas and visual access to the Listed Buildings
- Preserve of the site’s important heritage and provide long-term protection
- Improve the overall appearance by removal of derelict or incongruous modern structures
- Retain Canal & River Trust’s depot and operational facility

The proposed development would:

- Convert four Grade II Listed Buildings into 12 Dwellings
- Convert two buildings of historical importance
- Refurbish the existing vacant houses
- Add five new dwellings
- Create three dwellings above an existing building

There would be 25 dwelling units and 48 parking spaces.

You can provide us with your feedback

(Continued on page 14)

on this proposals at www.bulbournyard.co.uk and your comments will be taken into account in the development of the final scheme. (no closing date is given on that web

page.) A Chiltern Branch IWA officer attending the 23 February liaison meeting described the proposals as 'reasonable.'



As it is now

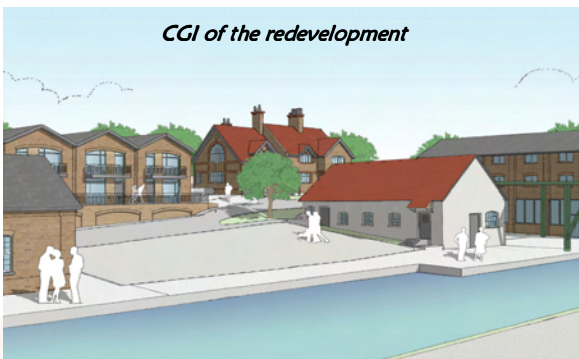

CGI of the redevelopment

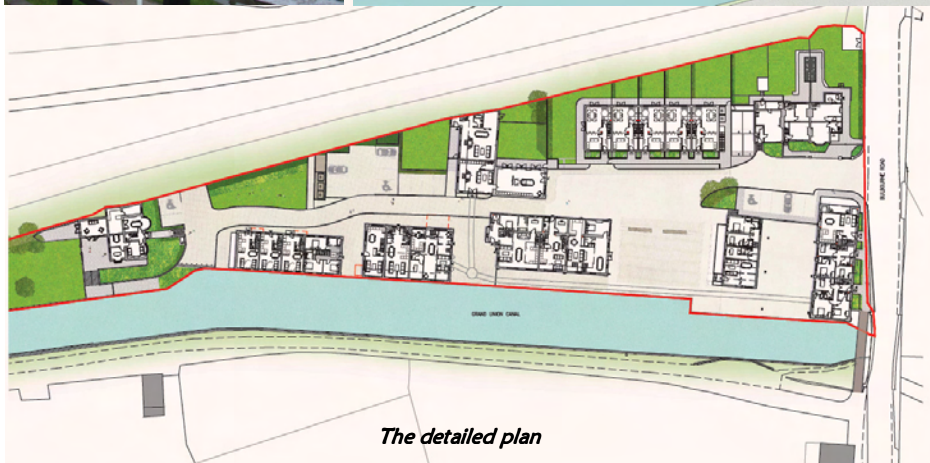

The detailed plan

Volunteers' Lunch

As a small token of thanks to the Trust's dedicated band of restoration volunteers Council invited them and their partners to a luncheon at Café in the Park on 16 January. About seventy in all with two dozen of them being the 'hard workers'

on the restoration team gathered at Aston Clinton and after a convivial buffet with a chance for them to meet and quiz Council Members, some of whom were, until then, just names on a piece of paper, they all lined up for the mandatory

'group mug shot'. The January Club 100 prizes and the raffle were drawn before

everyone departed for home



*O happy band of diggers, if onward ye will tread, with Roger as your Leader and Raymond at your head.
Photo: Ed*

HEYGATES Limited Flour Millers and Merchants



Visit our Website for Recipes

www.heygates.co.uk

Britain's Biggest Independent Millers

New Mill, Tring, Herts. HP23 4JN

Tel No 01442 823311 Fax 01442 890283

HLF bid Liaison Meeting 3 November 2015

The following is a summary of the questions and comments from the meeting and the answers given.



'Top Table' –from the left: John Dodwell CRT Trustee: Chris Sargeant, WAT Chairman: James Clifton, CRT

HLF BID AND FUNDS

Q Of the 1.6 million quoted HLF bid – how much from HLF as opposed to whole amount?

A *WAT funds will cover 15% HLF 85% Phase III A41 – Wendover – Costed in 2012 as £2.6 m. 2015 costs likely to be £3m. The HLF bid covers work from bridge 4 by contractors, WAT volunteers to work up to bridge 4.*

Q Does £1.2m just cover contractors?

A *Yes – volunteer costs are extra*

Q (from a member of Wendover U3A) You say we need 100 volunteers for the bid, is that in addition to the current number?

A *Any support that the U3A organisation could bring would be beneficial*

Q In a past lottery application WAT was criticised for only applying for funds to cover a part of the Wendover canal restoration and not applying for the total length

A *HLF are quite happy to fund for part of the project*

Q HLF funds will cover from bridge 4, how will this differ from now?

A *Volunteers work seven days per month contractors will work full time, they will also have increased efficiency due to not having to clear site the after every seven days work. Contractors will have access along cart track at bridge 4 and will be working in three places along the dewatered section.*

Q Contracting philosophy, is it CRT or re-tendered?

A *A CRT Term contractor who will*



John Dodwell making the opening remarks

work with WAT. These Term Contractors have been chosen from a table of competitive rates.

MAINTENANCE

Q Will CRT take over maintenance of the towpath?

A *It always has. Although WAT takes control of the canal bed at the point of*

restoration, CRT has always maintained the towpath

Q The main purpose of the restoration must be to get the water through to the reservoirs naturally?



James Clifton, leading the HLF bid on behalf of CRT

A *This is included in the HLF bid. Electricity will be saved when water is flowing naturally. This will also give a saving of CO₂ (a good green image). HLF interested in how maintenance will be financed in the future, this electricity cost saving can be used for this purpose.*

PHASE III

Q Will the canal towards Wendover (phase III) which is kept at a low water level leak when it is returned to its correct depth?

A *We do not know if it is watertight, original planning was to investigate and test this as the restoration neared completion. If contractors are used and phase II completed by 2017 CRT will have to bring forward feasibility study to align with new deadline.*

Water levels can be at various levels due to rainfall, it has been as high as 6-8 inches below original height. Fluorescine can be used to detect leaks (coloured

green water can be traced). Best method will be to put stop planks in and raise level gradually.

Q How much of the £3m for phase III will be needed for bridge alterations?

A *At 2012 costings:*

Buckland Wharf Bridge £300,000

Old A41 Bridge £600,000

Halton Bridge £900,000 (may be lift, swing or normal canal bridge) CRT issues guidelines for air draft of bridges.

Old A41 bridge would need a fender, to ensure boats travelled through the centre.

It is planned to have a narrows section leading from the Little Tring winding



Members of the audience listen attentively

hole to stop wide-beams from entering further along the canal, as otherwise they would have to reverse back. A notice board would explain the situation.

Comment from the floor *Looking at other restorations, these could be assessed individually*

Q Would a plan for bridges help the HLF bid as it would give a broader aspect?

A *No, narrative at bottom of HLF bid explains the situation*

Q What will be the attraction at the winding hole?

A *A41 winding hole is in a rural area, various mooring bays have been constructed for overnight stays along the restored section*

Q Does the HLF project include extending the winding hole?

A *WAT restoration volunteers will be available to work on two projects, extending the winding hole and raising the towpath at the Green Park narrows.*

Q Towpath near Green Park not good for runners?

A *Joe Sammon CRT Sports Participation Manager is aiming at the couch potato to encourage more active lifestyle, not fast professional runners. Miriam from CRT has run the route with a camera and checked to make sure there are no obstacles*

Comment from Jon Kelly – I've run the route and it is OK

PUBLIC PERCEPTION AND AWARENESS

Q My wife, Carol, is a volunteer at Wendover Library and she finds that many of the general public do not

realise that Wendover has a canal. Can we educate the general public more, can CRT help?

A *CRT Press office can help, Western Turville reservoir volunteers got £500 from the Wendover Parish Council even though it was not in their area. This was to improve access which flooded in winter.*

Comment from the floor The canals were built for £ profit originally, they should now be publicised as for "community profit"

Comment from the floor A charity walk gives more publicity than the planned marathon.

Q Newspapers always publish negative details, e.g. when canal floods?

A *Water levels are taken at regular intervals, the aquatic plants hold the water back, so it floods near Wendover. WAT would like CRT to dredge a channel alongside the towpath so water could flow more freely. WAT members give talks to local groups to promote the Trust.*

Photos in this article by the editor

Chiltern Branch IWA

The Branch's annual autumn weekend away this year will be from 30 September to 2 October and will be a visit to the Black country Museum with a trip into the Dudley tunnel, a day looking at

restoration on the northern reaches of the Ashby canal and a day on the Severn Valley Railway. WAT members are always welcome to join in. Further details in the summer Newsletter.

Members Small ads

25 YEARS OF WATERWAYS WORLD Wonderful historical record

From 1979 to 2014, all complete except one issue from 1985/1996/1997/2000/2005/2011; two from 1987/2004/2007 and no 2008. All in good condition. Donation to WAT only required. Could deliver to Wendover.

Nigel Williams, 01844 353927.

From the Archives The only pub on the Arm

Newsletter No 1 Winter 89

WATERING HOLE

One of the few buildings along the Arm which has remained virtually unaltered externally since the canal was closed to navigation is "The Buckland Wharf". Originally called The New Inn, it was refurbished by the Aylesbury Brewery Company who changed the name after hearing of the proposal to restore the Arm. The Buckland Wharf is situated on the A41 beside the canal and has been the venue for Trust committee meetings.

Newsletter No 2 Spring 90

WATERING HOLE DRIES UP

In the first issue of the Wendover Arm News we gave a brief report on the only public house along the Arm. We regret to report that, although trade had increased since the refurbishment of the Buckland Wharf about three years ago, economic pressures have now forced the Aylesbury Brewery Company to close the establishment. The final pint was pulled on Friday 23rd February and the premises are now "For Sale". Future walkers of the Arm will either have to carry a hip flask or walk fast enough to reach the Grand Junction Arms at Bulbourne before closing time.

Hmmm. . . Does the Committee have that effect on all watering holes? *Ed*

Tringford Pumping Station

This is a key operational asset for CRT, providing water to the GU summit at Tring. However, it is also a Grade II listed building with a number of serious fabric failures and defects affecting the integrity of the building. CRT has initiated a project to address the defects noted in the building and proposes to start work this summer. As a listed building the remedial works have to be done in line

with the 'best practice' standard for repair works to heritage assets the purpose of which is to ensure a consistent, approved approach to practical heritage conservation across CRT's estate.



Tringford pumping station in 2014. photo CRT

As well as the remedial works CRT proposes to improve the 'air conditioning' in the building to slow the rate of future internal deterioration and to improve the welfare facilities for CRT's staff.

CRT Volunteer Work Party on the Arm

CRT advertised for volunteering help for two days on the Wendover Canal. This was organised by Miriam Linford with assistance from CRT banksmen. As it was on our patch I decided to join in. On both days we had about 13 or 14 in total, volunteering from various organizations. Tring Anglers, Chiltern Society, WAT and regular CRT attendees. I was most impressed when a couple turned up on the Saturday from North London, they had seen it on the CRT website and thought a day out volunteering in the country was what they needed. Miriam soon set them off with paint brushes.

19 February was designated for reed removal on the section behind Wenwell Close Aston Clinton, this had become very narrow and the water flow was being restricted causing possible flooding at Wendover and low water in the reservoirs downstream. CRT's contractor had already cut through the reeds from the towpath, but we had to remove the still-embedded roots from the canal bed. The drag forks and grappling hooks to remove the weeds were hard work, when lifted with mud and roots attached the forks were extremely heavy and the grappling hooks sometimes caught securely in the roots, but then as

the roots gave way, the handler ended up sitting in the grass on the bank! On the off-side we had varying amounts of reeds left, but as the banks were private gardens we could not access this area. At one point a decking area had been built out into the canal to support a rowing boat. I felt that if the boat had been used more frequently on the canal it might have kept the channel clearer.

The next day we assembled at Tringford Pumping Station to clear the vegetation from the walls and clear brambles so that troughs (originally diesel tanks) could be filled with seasonal plants.

Miriam managed the work party well and we had the use of a welfare van that had a toilet, hot water for drinks and very comfy seating. It had been hired for a week and used the previous weekend at another work party. This must have cost CRT, and it could be said that driving us in their normal van to the Café in the Park for refreshments and relief might have been cheaper.

Both sites looked vastly improved at the end of the work parties.

Acknowledgments to 'Bob' for the extracts from his diary and to CRT for the pictures at Aston Clinton – Ed



Donations

It has been a good three months for donations. In addition to the £100 from the donor who doubled up his Easyfundraising target and who wants to remain anonymous (see letter p7) we have received the following:

Mike Chessher who was instrumental in our Millennium Lottery Fund bid (unsuccessful but not his fault) wrote after receiving the winter Newsletter, 'I am sorry to read of Brian's death and also that of John Brown. Incidentally I once told him to get his car off the field in no uncertain manner, much to his amusement and that of Roger Lewis who came rushing over to introduce us' and enclosed a cheque for £500.

Rose Bennett's bric-a-brac stall at Dunstable and District Boat Club has raised a further £118.31 and the total from Rose now stands at £2467.12 . . . just going to show that one man's junk is another man's treasure.

Tim Armstrong from the **IWA MK Branch** writes 'At the branch's recent AGM, it was agreed that once again the branch should support the efforts of the Wendover Arm Trust in its aim to restore the Wendover Arm of the Grand Union Canal. This is a campaign which we believe is gaining wider recognition for its success and progress. As a result of the vote at our AGM I enclose the Branch's cheque for the amount voted, £300.'

David Ager writes "Thank you for the cheque of £232.80 it was a lovely surprise. I have been quite lucky on the Club 100 raffle over the years, so please find enclosed £100 towards restoration.'

David Page says, 'I only subscribed to the Eraffle to boost the numbers so it was a surprise to win and, as a Council Member, something of an embarrassment. So, here's a donation of £100 towards the restoration.'

In January our Chairman received a cheque from **IWA Chiltern Branch** for £1000. No particular reason for the donation, just the branch being generous, and this after the £2000 donation last year for our events trailer (see winter



2015 Newsletter). The photo above shows Chris receiving the cheque from Chiltern's Chairman, Dave Chapman.

Wendover Rotary has donated £200 following Ray's talk to them a year ago and we have received £200 as our share in **IWA's 2015 Christmas Draw**.

. . . And with the £5000 legacy from Stuart Bell's estate, reported in the winter 2015 newsletter and just received, the total is over £8100.

GRAND DRAW 2016

Thank you all for your generosity last year in making the 2015 Draw the most profitable ever. Can we do even better this year? The prize list is being compiled and tickets are being printed. Tickets will be on sale as from the first event of the year (Wendover Celebrates on 1 May) and a couple of books will be sent to you all in the summer Newsletter. Once again we do understand that some people, for a variety of reasons, don't buy raffle tickets but it is easier to do it this way rather than work by exception.



- 1st Prize:** **Week on a Canal Boat**
sponsored by Wyvern Shipping Co Ltd
- 2nd Prize:** **A Day Boat Hire**
sponsored by Lee Valley Boat Centre
- 3rd Prize:** **Virgin Experience Day - The Shard**
- 4th Prize:** **£100 Cash**
- See website www.wendoverarmtrust.co.uk
for complete prize list

The DRAW will take place on Restoration Open Day, 4 September, at Drayton Beauchamp church

Tickets sponsored by MORGANS PLANT HIRE - 01844 237874 - HELPING RESTORATION

News from our Neighbours

Buckingham Canal Society Work continues at Cosgrove through the winter. MK Dons have bought the fields on either side and have agreed access for BCS plant, delight as the volunteers now won't have to construct bunds by hand. Bridges 1 and 2 at Cosgrove are being excavated and if 50% or more of the structure remains the Society plans an HLF application to rebuild. Tests to re-water the pounds west of Bridge 1 to check for leakage are taking place and with CRT will make a plan to seal any leaks and are hoping that the section up to Bridge 2 can be re-watered before the year is out.

Bedford and Milton Keynes Waterways Trust is all excited at the prospect of at last being able to start work on the ground at the Milton Keynes end, a project has been announced that will dig the beginning of the route at Campbell Park to allow access to a new marina being built in association with housing and other facilities.

Aficionados of **Call the Midwife** will have seen Bulbourne (and Braunston Bottom Lock) posing as Poplar in the episode on Sunday 28 February. What was wrong with shooting the scenes locally, not picturesque enough?

Membership Update

The winter months are the quietest of the year, however that doesn't mean that nothing has been happening in the membership arena. Although we have not had our stand out and about at local events, we have still recruited a number of new members.

The Trust wish to extend a warm welcome to the following new members who have joined us in the last three months or so:

Mr Derek and Mrs Deirdre Barker
from Wendover
(life membership)

Mr Stephen Miller
from Radlett

Dr William Bell
from Birmingham,
(son of the late Stuart Bell)

Mr Robert Lansley
from Wolverhampton
(brother of the late Brian Lansley)

Thrupp Canal Cruising Club
corporate membership

We welcome them all and wish them many happy years of membership of the Trust

Goodbye

Mr Richard Longhurst after 12 years as a member,
and we are sad to record the passing of
Doreen Boden and **Dorothy Brown**
although Christopher Boden and James Brown continue as members.

Gift Aid

Following my appeal in the winter edition for new declarations to be completed, a number of members have come up

trumps by submitting a new form for Katherine to hold on file. There are 95 membership households who are yet to do this, so if you live in one of them, please act now to ensure your future membership subscriptions and donations are eligible for GiftAid. This is an HMRC requirement. If you need a new form, simply download it from our website or contact Katherine for a paper copy. Forms can be returned in the post or by email. GiftAid is currently worth an additional 25p for every £1 you donate, at no cost to yourself, so please complete a new mandate. If you are no longer a tax payer or simply wish to leave the scheme, please inform Katherine, as it is the donor's responsibility to update the charities they support.

Thank you for your help.

Golden Giving

The Trust has been working with Tring based Golden Giving for a few years now, but it is a good opportunity to inform members of our relationship with Golden Giving and how they help us to reach more supporters through the internet. This is how Golden Giving describe themselves:

Golden Giving is a secure, integrated and seamless online platform for charities to process individual and regular donations, promote events, sell tickets, raffle tickets and memberships, discover and connect with supporters and more, for free, forever.

There are the mainstream online providers such as Virgin Money Giving, Just Giving and Local Giving all charge charities fees to use their services, which Council felt

were not justified given our small online presence and low turnover.

The only fees that are taken from transaction monies are the bank processing fees that are levied for processing the card transaction. For debit cards it is 18p per transaction and credit cards is 1.45% of the total value spent.

Wendover Arm Trust use the membership database function and GiftAid log. This means that your personal details as entered on your membership form are entered into the secure database. Golden Giving submits our Gift Aid claim to HMRC on our behalf and HMRC pays the monies owed directly to WAT. There are no fees for this service.

What are these emails I receive?

Each time you renew your membership and/or make a donation, Katherine logs it on the Golden Giving database under your own personal record and GiftAid is claimed if applicable, this process triggers the confirmation email. If you pay online directly through Golden Giving, you will get the email as confirmation of

your transaction.

The Wall

We have a charity page called The Wall on the Golden Giving site, <http://www.goldengiving.com/w/wendover-arm-trust>, this has information about our charity, links to our own website and displays forthcoming events and summaries of donations and raffle tickets bought recently. It does not list membership details.

Can my donation or ticket purchase be anonymous?

When a transaction is logged, there are several tick box options including asking you whether you would like your donation to be kept anonymous. The default value is 'no', so if you wish your contribution to be anonymous, then please include a note for Katherine with your cheque or contact her if you pay by standing order/BACS transfer. If you do your own online transaction, then you can choose to check the anonymous box or not. You need to opt out of this process should you wish to do so.

MARKET AUTO CENTRE LTD

MORTIMER HILL, TRING

- ☐ Servicing and repairs on all types of vehicles
- ☐ MOTs – Petrol, diesel and catalytic converters
- ☐ Tyres, batteries and exhausts
- ☐ Friendly, personal service

ALL AT COMPETITIVE PRICES

Tel: 01442 826767

Club 100

The 74th Club 100 lottery draw was made on Saturday 16 January at our volunteers lunch. There were 194 subscribers in the draw, a few less than the record number for the autumn draw

The winners were:

1st	Mr David Ager	£232.80
2nd	Mrs Ann Davidson	£97.00
3rd	Mr William Morton	£38.80

Congratulations to all our winners and thank you for being a part of our fund-raising lottery.

If YOU would like to be in with a chance of winning the next jackpot in April, join today. Each lucky number is £15 per year which covers four quarterly draws throughout the year. The Club 100 is exclusive to Wendover Arm Trust members.

Can YOU help us to have 200 subscribers for our 75th draw in April?

E-Raffle

This was drawn on 17 February and the winners were:

1st	£100	David Page
2nd	£50	Michael Wright
3rd	£30	John Dodwell
4th	£20	Wayne Hambridge

573 tickets were sold and the net proceeds were £564.39

HELP WANTED

EVENTS 2016

If you can help in any way at any of the events below, even just for an hour or two your help would be much appreciated. Our ability to be at these events depends on volunteers, you do not need to be an expert on the canal and its restoration, there are many other ways in which you can help

1 May Wendover Celebrates

2 May Aldbury Spring Fair

28 May Hulton Bridge Boaters Party

19 June Marsworth Steam Fair

25 June Tring Carnival

23 July Linslade Canal Festival

11 Sept Halton Village Fête

11 Sept Two Arms and Two Legs Challenge

plus our two **Restoration Open Days** at Drayton on **5 June** and **4 September**

In addition CRT is organising a Two Arms and Two Legs Challenge, a half-marathon plus a 10k run plus a family fun run from Aylesbury to Marsworth and to Wendover for the half-marathoners.

We've been asked if we can man water stations at Marsworth and at Halton and we'd like to oblige but it's the same day as the Halton Fête and without a goodly supply of helpers we are not going to manage both events. For more detail see:

<https://canalrivertrust.org.uk/enjoy-the-waterways/events/2016-09>

Can you (will you?) help. Contact Jenny on events@wendoverarmtrust.co.uk or leave a message on 07547 181857



WENDOVER ARM TRUST

President
Vice President
Patron

Dr David Fletcher CBE
Barry Martin
David Suchet CBE

Wendover Arm Trust, A Company Limited by Guarantee. Registered Charity No.801190. Its **AIMS** are:

To promote the restoration and maintenance of the Wendover Arm of the Grand Union Canal, (including all waterways, buildings, and related structures), to good and navigable order and to promote the fullest use of the waterway by water-borne traffic (subject to the regulations of The Canal and River Trust) and for local amenity, recreational and water related activities for the benefit of the public.

To restore, preserve, maintain and to educate the public in the history, use and associated wildlife, of canals and inland waterways generally and the Wendover Arm in particular.

General telephone number: 07547 181857 **Website:** www.wendoverarmtrust.co.uk

Registered Office: Fox Meadow, Water End Road, Potten End, Berkhamsted, Herts HP4 2SH

Advertising Enquiries:

Contact either the Publications Director or the Publicity Director, (Email addresses on p3)

Or speak to the Newsletter Editor on 01494 863176

The views expressed in this journal are those of the contributors and cannot be taken as those of the Council of the Wendover Arm Trust. Whilst all reasonably practicable steps are taken to confirm the accuracy of any statements herein, no liability can attach to the Editor, or the Council of the Wendover Arm Trust, or any contributors for any errors and neither the Editor nor the Council of the Wendover Arm Trust accept any responsibility for any consequences however caused.

Green Park Activity Centre
Aston Clinton, Bucks

We offer a fun, challenging and safe environment for families and children to enjoy a wide range of exciting indoor and outdoor activities. From Archery and Mountain Biking to the heady heights of Climbing and Zip Wire.

Booking now for Family Days, School Holiday Activity Days and Birthday Parties all with a sense of adventure!

www.alfvillages.org.uk
0330 303 0101





FLYING HIGH

FOR 2016, ALL OUR
MONTHLY BEERS
ARE NAMED AFTER
DE HAVILLAND
AIRCRAFT



FOR 2016 WE'VE TEAMED UP WITH THE DE HAVILLAND AIRCRAFT MUSEUM, HELPING RAISE FUNDS FOR THEIR NEW HANGER PROJECT. THIS FACILITY WILL HOUSE SOME OF GREATEST AIRCRAFT OF ALL TIME AND HELP PRESERVE A COLLECTION THAT INCLUDES THE MOSQUITO, TIGER MOTH AND COMET.

HEAD TO THE BREWERY SHOP IN 2016 TO PURCHASE ANY OF THE MONTHLY SPECIALS AND YOU CAN BE IN WITH A CHANCE TO WIN A TOUR OF BOTH THE DE HAVILLAND AIRCRAFT MUSEUM, TRING BREWERY AND A FLIGHT IN A DE HAVILLAND BIPLANE.

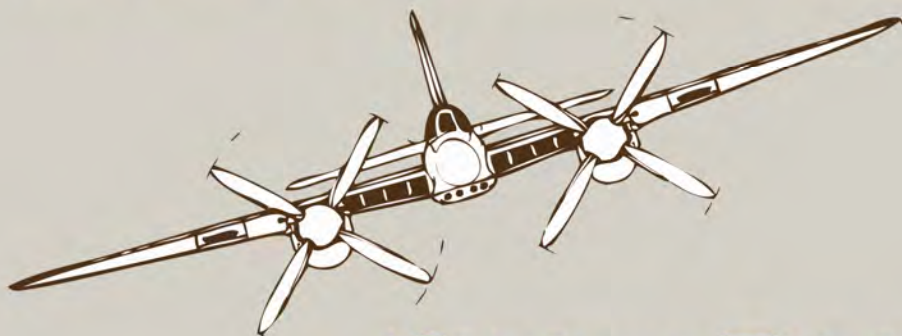

TringBrewery



TringBrewery

www.tringbrewery.co.uk 01442 890721

TRING
BREWERY Co.



Excellent Boats on a Beautiful Canal

Our base at Linslade is within weekend reach of the Waterways Museum at Stoke Bruerne, or the Chiltern Hills and Aylesbury. Choice of exciting one- or two-week cruises including the Thames. 35 luxury boats, 2 to 8 berth.

Boat Builders - Repairs - Dry dock - Blacking - Repaints
Waterside holiday cottage

The WYVERN SHIPPING Co Ltd

Rothschild Road, Linslade, Leighton Buzzard, Beds, LU7 2TF
Tel: 01525 372355 Fax: 01525 852308

<http://www.canalholidays.co.uk> james@canalholidays.co.uk

Members of IWA, APCO, BMF, B&MK Waterway Trust, Wendover Arm Trust, Buckingham Canal Society, Aylesbury Canal Society



**Digital
Services
Limited**



**IT Support
Networks
VoIP Systems**



www.digitalservices.co.uk

info@digitalservices.co.uk

01442 828995

An Autarkic Free house



Open All Day

Great Food

Local Ales

Prosecco on

Tap

Takeaways

Pizzas

The Anglers Retreat

Marsworth, Tring HP23 4LJ 01442 822250



Q8 Oils
MORRIS
LUBRICANTS



BARTON
PETROLEUM
www.bartonpetroleum.co.uk

Your first call for Fuel & Lubricants...

For all commercial and residential fuels 01923 233171

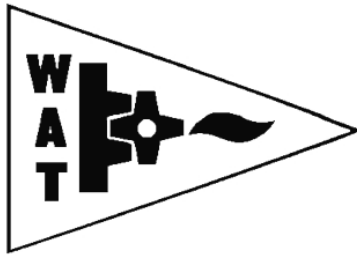

Booking form for Wendover Arm Trust Barbecue

Saturday 14 May 2016 at Your Café in the Park, Aston Clinton

12 noon—3pm

Indoor accommodation if wet. Free drink on arrival thereafter cash bar/cafe

I/We would like to buy tickets for the Barbecue @ £10.00 per person

I/We enclose a cheque (payable to Wendover Arm Trust) for £

Name(s) of those attending, please tick the final box if you want the vegetarian option :

1	NAME	<input type="checkbox"/>	2	NAME	<input type="checkbox"/>
3	NAME	<input type="checkbox"/>	4	NAME	<input type="checkbox"/>
5	NAME	<input type="checkbox"/>	6	NAME	<input type="checkbox"/>

No tickets will be issued.

Your booking will be confirmed by Email, phone call or text message

Mobile phone number

Landline phone number

Email address

Please send this form and payment to:
Jenny Brice, Woodstock, Cedars Close Chalfont St Peter Bucks SL9 0LL

Enquiries please to events@wendoverarmtrust.co.uk